

# FMS Forest Motorized System / Shuttle

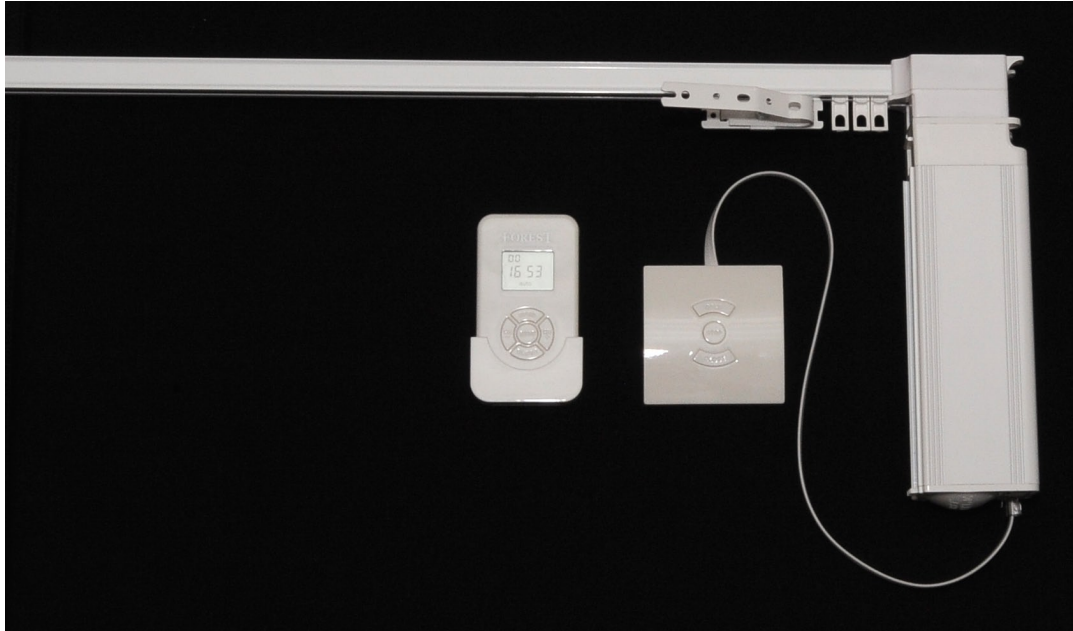

Forest SHUTTLE Motor Technology is now available made to measure by JACKSON.

The Forest SHUTTLE motors can be operated in three ways:

- Wall switch
- Multi channel RF remote with timer
- Touch Impulse Technology - This technology allows you to open or close the drapes with a gentle pull. Just gently pull the drapes in the direction you want and the motor does the rest.

In case of a power failure, the drapes can be moved manually with no harm to the motor. The multi-channel remote has a range of approximately 30 meters and can operate several motors in unison using channel 00, or separately by using channels 1-15. The Forest SHUTTLE offers a very quiet operation with a speed of 15cm per second.

The Forest SHUTTLE has a 24 volt DC motor with 115 volt A/C power adapter. There is no need for an electrician if a wall outlet is available. The maximum length allowed is 5.8 meters (228"). The rated maximum weight is 10kgs. per meter of track (approx. 7 lbs. per foot) for standard pinch pleat style drapes. The Forest SHUTTLE offers a 10 year warranty!

## Suggested Retail Pricing

Width	4'	6'	8'	10'	12'	14'	16'	19'
Price	\$1400	\$1450	\$1500	\$1550	\$1600	\$1650	\$1700	\$1750

QTY	Width	Single Double (2x price)	Stack One way Right One way Left Two way Center	Motor Side Right Left	# of Carriers Standard is 3 per foot	Mount Wall Ceiling

# FMS Forest Motorized System / Shuttle

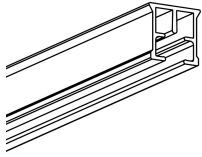

**H FMS1000-580**  
Track 5.8 mtr length  
White



**H FMS1001**  
Shuttle Motor  
Motor works in touch mode only unless a wall switch/receiver is attached

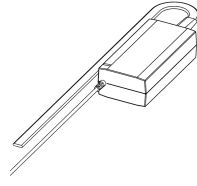

**H FMS1002**  
24 volt adapter



**H FMS1004**  
Wall bracket for  
H FMS1002

**H FMS1003**  
USA/CANADA  
Power Cord for  
H FMS1002

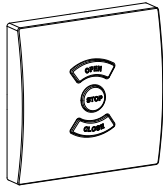

**H FMS1005**  
Combination RF receiver and wall switch, plugs in to port 1 of the shuttle motor



**H FMS1006**  
Multi remote white 15 channel includes cr2430 battery  
H FMS1005 must be used as a RF receiver for the multi remote

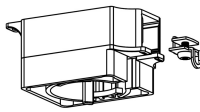

**H FMS1009**  
Motor pulley housing

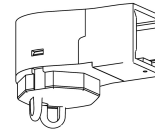

**H FMS1010**  
Idle end pulley

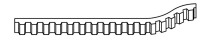

**H FMS1011**  
Drive belt  
100 meter roll

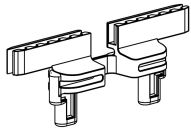

**H FMS1012**  
Drive belt connector one required for each master carrier

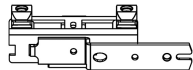

**H KS52509-25**  
Left underlap master carrier, arm is reversible

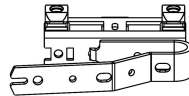

**H KS52508-25**  
Right overlap master carrier, arm is reversible

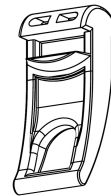

**H KS52008-25**  
Heavy duty carrier  
10 per strip

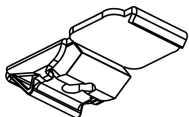

**H KS3003-25**  
Smart klick ceiling bracket

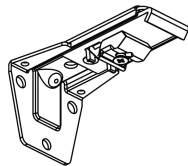

**H KS53202-25**  
Smart klick wide base bracket  
3-4 1/2" projection

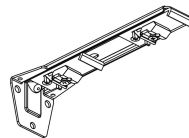

**H KS53206-25**  
Smart klick wide base bracket Double  
3-4 1/2" & 6-7 1/2"